

PRODUCT INSTRUCTIONS

HUANGSHAN DRX INDUSTRIAL CO., LTD.
NINGBO EVEREST ENCLOSURE TECH CO., LTD.
Factory add: Huangshan Industrial Zone, Huangshan, Anhui
Office add: 18F, Building 1, Wisdom Valley, No.18 Technology
Road, Cixi, Ningbo, China 315300
TEL: +86-574-23661202 +86-559-8516098
FAX: +86-574-23660328
Email: sales@everestcase.com
Web: www.rhino-case.com www.everestcase.com

■ Instruction for opening the case

Please open the case accordingly based on different locks.

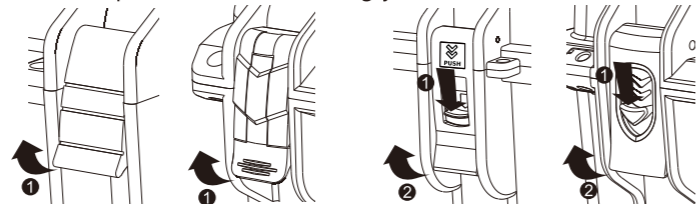

① Open the lock hard

① Push button down

② open the lock

* Some models of latches are designed with a locking switch, which can prevent abnormal opening of the latch after locking.



■ Instruction for shoulder strap

EPC Case

Open the case and insert the metal sheets of shoulder strap into installation slots on both sides of the case.

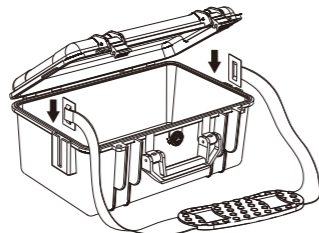

RPC Case

Hook the metal spring hooks to the metal pins on both sides of the case

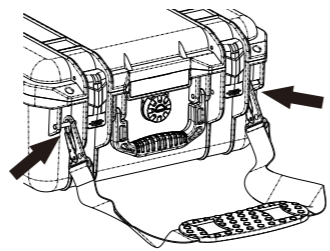

* Not all cases will be equipped with shoulder strap.

■ Instruction for pressure-balancing valve

It will be hard to open the case when the pressure changes definitely. The valve will help balance the inside and outside pressure to open the case easily.

EPC Case

Manual pressure balancing valve, open the valve counterclockwise, close it clockwise.

* Please don't close it tightly, or the valve will be broken possibly.

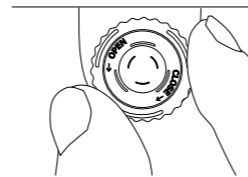

RPC Case

Automatic pressure balancing valve helps to adjust the inside and outside pressure.

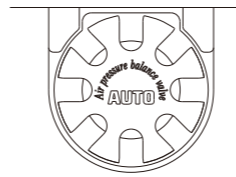

■ Instruction of Foam

Pre-cubed foam: Place the instrument on the foam and use marker mark the outline, then move the cubed foam in the outline.

Use rubber adhesive to glue the extra cubed foam.

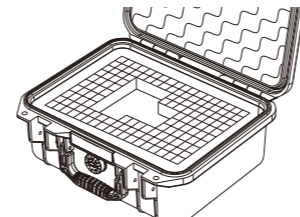
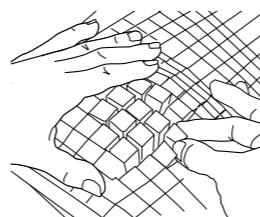

■ Instruction for Label

Open the case, the transparent panel in the front of case can be pulled out, then take out the label paper, write something down and replace it.

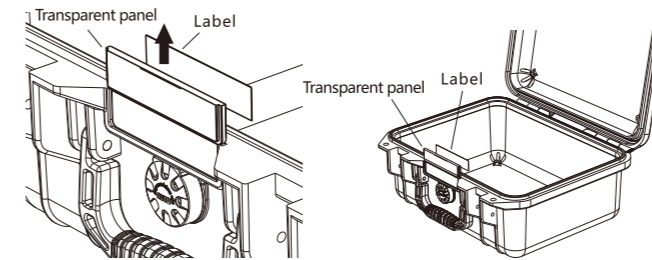

* Not all cases are with label.

■ Instruction for combination lock

The case can be equipped with three-dial combination lock. Open the combination lock before patented lock.

Opening your combination:

Roll the three dials until the appropriate number, and push the lock button to the right.

Resetting your combination:

Hold the lock button to the left, roll the dials until you have your new combination, then loose the button.

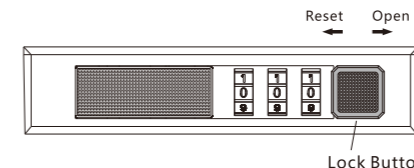

* Only partial cases are equipped with combination lock.

⚠ Use and Protect Tips

Please make sure the sealing in the lid to be good and clean to ensure the seal of case.

Use cloth to clean the case, not organic solvent like alcohol or brush since it will damage the surface of case.

Keep away from the heat or direct sunlight conditions to prevent damage, deformation, discoloration, burn, etc.

Avoid a strong impact on the body otherwise it may be damaged. Keep away from baby and children.

Polar solvents such as lipids, ketones and chlorinated hydrocarbons will corrode ABS material. Please do not use solvents containing such chemical components to wipe the cabinet or glue the box.

■ Waterproof Recognition

It's inevitable that the protection level, IP67, will be lower later with case deformation, sealing strip aging, accessory damage, etc., please confirm the waterproof performance before use.

■ Quality Commitment

Replacement can be provided within 15 days after sale (Non-human factors and force majeure).

The warranty time is 2 years (freight is by customer). We will deal with the complaints within 24 hours after receiving your feedback, and prove the "three guarantees".

We promise repair, replacement, return within validity of "three guarantees" if any quality problems are found.

The following conditions are exceptions and customer has to bear the fee:

1. Damage caused by neglect the instruction;
2. Damage caused by deliberate human behavior;
3. Damage caused by usage beyond the product performance;
4. Damage caused by private modification and disassembly;
5. Other damage caused by case damage;
6. Damage caused by shipment after sale;
7. The waterproof and breathable film in the sealing strip and the air pressure balance valve are consumables and are not covered by the warranty.

* The company reserves the right to modify this manual at any time without notice.